

NOTE
 All finished work, including, but not limited to, all base
 of street to be finished and installed by other prior
 to paving work.

Electrical M.H.
 10' x 10' x 10' (10' x 10' x 10')

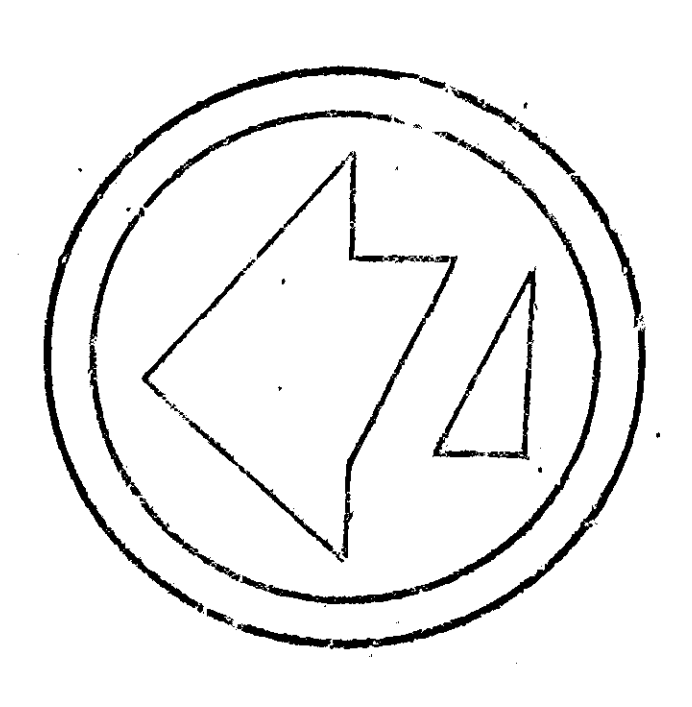

Scale 1"=20'

REV. NO.	DESCRIPTION	DATE
1	Added Street Lane to Driveway	11-22-46
2		
3		
4		
5		
6		
7		
8		
9		
10		
11		
12		
13		
14		
15		
16		
17		
18		
19		
20		
21		
22		
23		
24		
25		
26		
27		
28		
29		
30		
31		
32		
33		
34		
35		
36		
37		
38		
39		
40		
41		
42		
43		
44		
45		
46		
47		
48		
49		
50		
51		
52		
53		
54		
55		
56		
57		
58		
59		
60		
61		
62		
63		
64		
65		
66		
67		
68		
69		
70		
71		
72		
73		
74		
75		
76		
77		
78		
79		
80		
81		
82		
83		
84		
85		
86		
87		
88		
89		
90		
91		
92		
93		
94		
95		
96		
97		
98		
99		
100		

APPROVED: [Signature]
 CITY ENGINEER
 DEPARTMENT OF ENGINEERING
 CITY OF SAN BERNARDINO
 ACCESS ROAD
 Between South E. 11th and a point 300 ft. West
 of [Point]

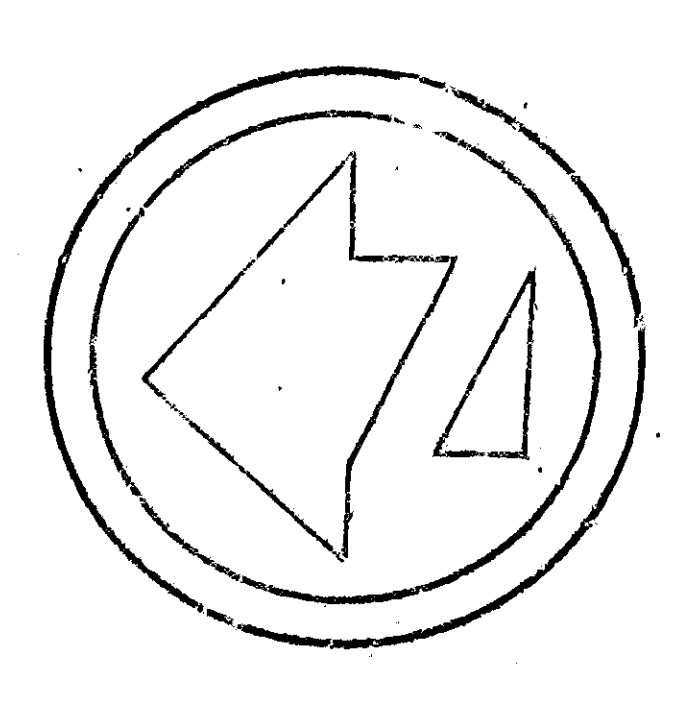


Scale 1"=20'

APPROVED	DESIGNER	DEPARTMENT OF ENGINEERING	APPROVED
CITY ENGINEER	CITY ENGINEER	CITY OF SAN BERNARDINO	
DRAWING NO. 10000	DRAWN BY	ACCESS ROAD	
CHECKED BY	CHECKED BY	Between South E. Mill and a point 300 ft. West	
SHEET 2 OF 3	RECOMMENDED		